

OptiFlex B
For easy
and quick
color changes

Display pilot
with 3 preset programs

Free programming
and program memory

Best ergonomics
for appliance and gun

DVC
Digital Valve Control
for exact and reproducible
powder delivery

Integrated metallic
applications

Maximum coating perform-
ance with all powders

On-gun remote control
for program selection
and powder output

Quick-change connector
for powder hose



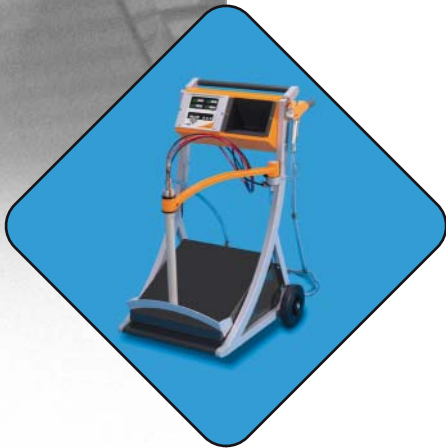

OptiFlex

Reliability and flexibility for the powder coating of the 21st century

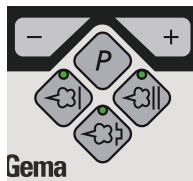

OptiSelect

For fatigue-free coating, a manual gun has to be perfectly balanced, light and ergonomic. During the development phase of the **OptiSelect** series, a special focus was put on these important criteria.

The **OptiSelect** is completely prepared for the use of metallic powders.

The quick-change connector for the grounded powder hose and the on-gun remote control also contribute to comfortable and quick coating.

OptiSelect is tested in compliance with the standards in force, which provides you all the safety you require!



OptiStar

Display pilot

The **OptiStar** control unit includes 3 preset standard programs. They are perfectly configured to coat flat parts, complicated parts, recoat parts and can be easily selected via the display pilot.

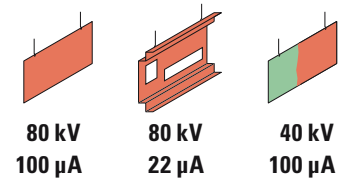

80 kV
100 µA

80 kV
22 µA

40 kV
100 µA

Up to 20 coating programs can be stored in the **OptiStar** control unit. High voltage, spraying current, powder output and total air volume are comfortably and precisely controlled via the foil keyboard.



High-tech for perfect powder output

The patented DVC technology (Digital Valve Control) guarantees a highly precise powder output and reproducible coating results.

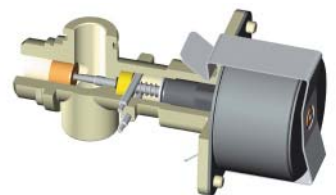

OptiFlex B

OptiFlex B For easy and quick color changes

OptiFlex B is especially designed for the use of original powder boxes. The inclined vibration plate allows complete emptying of the powder boxes via the fluid/suction unit.

The solid and very ergonomic unit ensures trouble-free treatment of all currently available powder types, even metallic powders!

OptiFlex B: quick and easy color changes carried out within a few seconds.

The system comes ready to use and can be put into operation after a short assembly time.

As an option, **OptiFlex B** is available with two control units and two guns.



- | | | | |
|---|-----------------------|---|-------------------------------|
| ① | OptiStar control unit | ⑥ | Vibration table |
| ② | OptiSelect manual gun | ⑦ | Swivel arm with guide bushing |
| ③ | OptiFlow injector | ⑧ | Air filter unit |
| ④ | Solid frame | ⑨ | Conductive powder house |
| ⑤ | Fluid/suction unit | ⑩ | Storage compartment |



Technical Data OptiFlex B

Electrical Data

Rated input voltage 1/Connected load	230 – 240 VAC/150 VA
Rated input voltage 2/Connected load	110 – 120 VAC/220 VA
Frequency	50 – 60 Hz
Rated output voltage (to gun)	max. 10 V eff.
Rated output current (to gun)	max. 1 A
Vibrator connection and -power (at AUX-Output)	110/220 VAC max. 100 W
Type of protection	IP 54
Temperature range	0 °C to +40 °C +32 °F to +104 °F

Pneumatical Data

Main compressed air input (at filter unit)	G ¼" internal thread
Max. input pressure	10 bar/145 psi
Min. input pressure (dynamical)	6 bar/87 psi
Max. water vapor content of compressed air	1,3 g/Nm ³
Max. oil vapor content of compressed air	0,1 mg/Nm ³
Max. compressed air consumption	8 Nm ³ /h

Measurements

Width	690 mm
Depth	800 mm
Height	1135 mm
Weight	58 kg
Max. size of powder box W x D x H	510 x 500 x 390 mm

Certificates

PTB
ATEX
FM

ITW Gema AG
Mövenstrasse 17
CH-9015 St.Gallen
Switzerland

Tel. (+41) 71-313 83 00
Fax (+41) 71-313 83 83
info@itwgema.ch
www.itwgema.ch



OptiFlex

Reliability and flexibility
for the powder coating
of the 21st century

ITW Gema AG reserves technical changes without prior notice

OptiFlex B